

MOOG GmbH · Im Gewerbegebiet 8 · 88693 Deggenhausertal

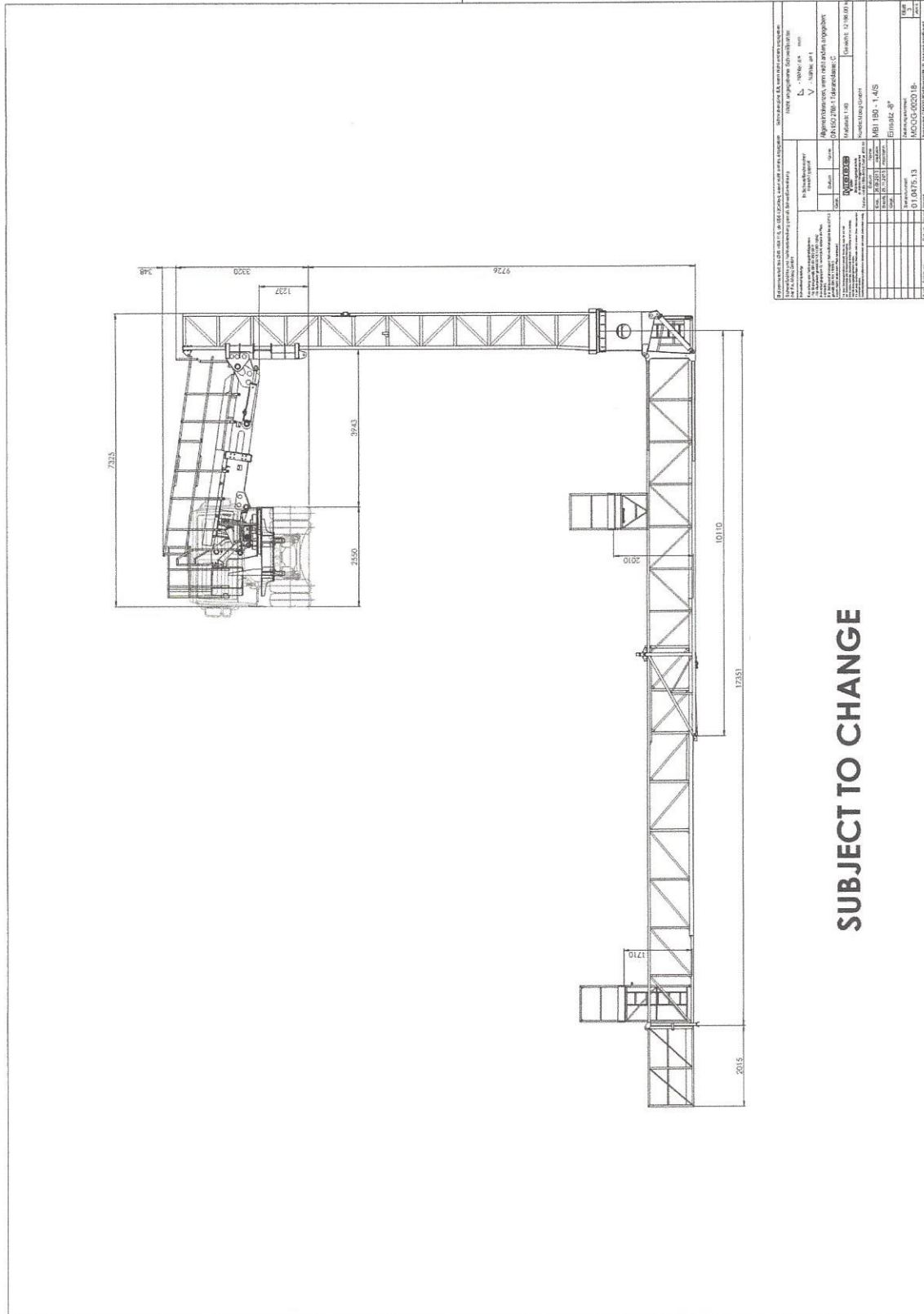

SUBJECT TO CHANGE

drawing 4: operation position of MBI 180-1,4 –max. lowering depth

MOOG GmbH · Im Gewerbegebiet 8 · 88693 Deggenhausertal

1 Specification of MBI 180-1,4 – new version truck mounted

	MBI 180-1,4
Max. Horizontal range	18.0 m
Max. lowering depth	9.7 m
Width of platform	1.4 m
Space required on bridge	2.5 m
Max. load on platform (kg)	600 kg
Max. load on telescopic platform (kg)	300 kg
Rotation of platform	180 °
Max. overbridging of sidewalk	3.7 m
Max. crossing of sound barrier	4.0 m
Transport dimensions	
Dry weight	32,000 kg
Overall length	12.0 m
Overall width	2.5 m
Overall height	4.0 m

The Unit includes the following equipment:

Bridge Inspection Unit:

- MOOG Unit, upper structure type MBI 180, mounted on truck
- The machine can be operated on the right hand side of the road only

Control panels

- Operator panel on rear of truck for assembly and disassembly of the upper structure

